

API 602

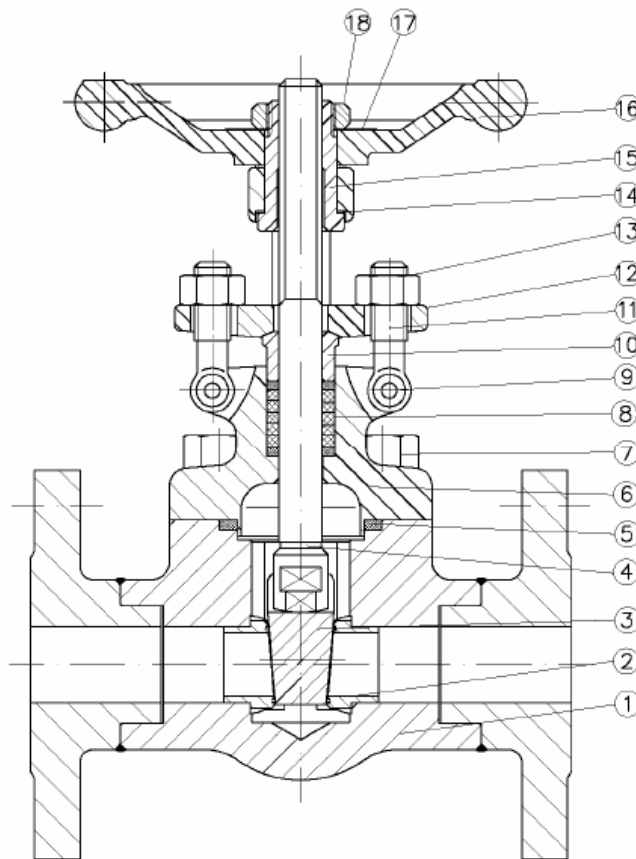

Item	Description	Material	
		Carbon Steel	Stainless Steel
1	Body	A105	A 182 F316L
2	Seat	A 182 F6A	A 182 F316L
3	Wedge	A 182 F6A	A 182 F316L
4	Stem	A276-410	A 182 F316L
5	Gasket	SS-304+Graphite	AISI 316 + Graphite
6	Bonnet	A105	A 182 F316L
7	Bolt	A193-B7	A 193 B8M
8	Packing	Flexible Graphite + Carbon Fibre	Flexible Graphite + Carbon Fibre
9	Pin	AISI 420	AISI 304
10	Packing gland	AISI 420	AISI 316L
11	Eye bolt	A 193 B8	A 193 B8M
12	Gland Flange	A276-410	A 194 8M
13	Hex Nut	A105	A105
14	Washer	AISI 410	AISI 410
15	Yoke nut	AISI 410	AISI 410
16	Hand wheel	A197	A197
17	Nameplate	Aluminium	Aluminium
18	Hex nut	1035 Zinc plated	1035 Zinc plated

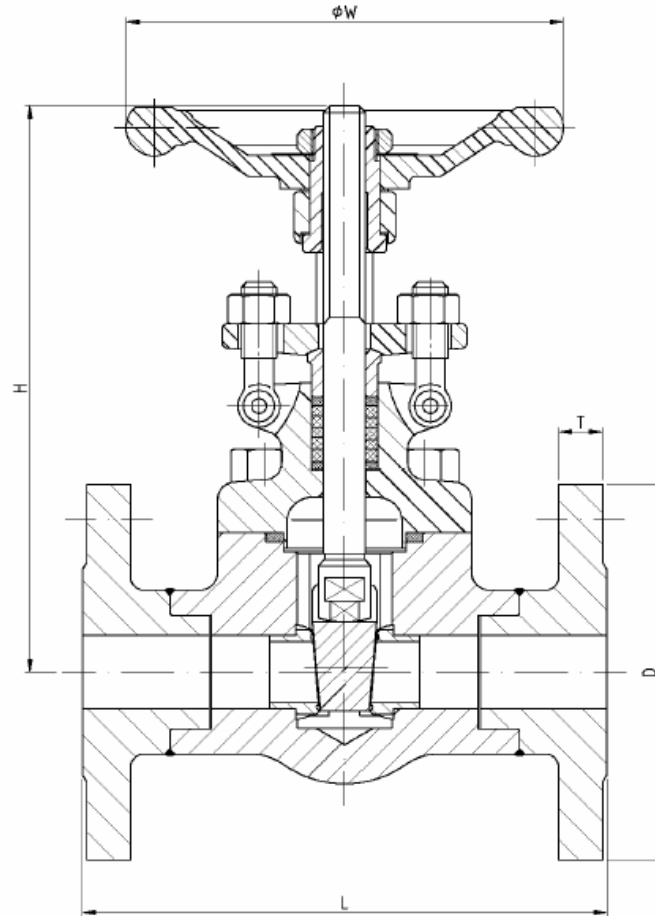



DN	L	H	ØW	WEIGHT	D	D1	D2	T
15	130	166	100	4	95	65	45	16
20	150	163	100	5,1	105	75	58	18
25	160	193	125	6,5	115	85	68	18
32	180	230	160	11	140	100	78	18
40	240	246	160	13,3	150	110	88	18
50	250	263	160	20,1	165	125	102	20

(*) Dimensions in mm and weight in kg
For other sizes consult to the technical department.

DESIGN STANDARDS		
Valves design	API 602	
End to End Dimensions	EN 558-1 series 1 (DIN 3202-F1)	
Flanged Dimensions	EN 1902-1 formB PN40	
Visual Inspection	MSS SP- 55	
Marking	ISO 5209	
TESTS AND CERTIFICATES		
Pressure testing	EN 12266-1	
Shell test	6.0 Mpa	
Seal test w ater	4.4 Mpa	
Seal test air	0.6 Mpa	
Suitable medium	W. O. G.	

Kv Values in m3/h	
DN	Cv
15 (½")	15
20 (¾")	15
25 (1")	29
32 (1 ¼")	80
40 (1 ½")	80
50 (2")	135

PRESSURE - TEMPERATURE (Standard Class According to ASME B16.34)		
Temp	MATERIAL	
	A105	AISI316
°C	Bar	Bar
0-20	40,0	36,4
50	40,0	34,8
100	40,0	31,5
150	39,2	28,8
200	38,0	26,1
250	36,0	24,4
300	32,0	22,6
350	28,0	21,3
400	22,0	20,4